

PA200 and PA500

Digital Precision Altimeters



Applications

- ROV and AUV altitude
- Under ice measurement
- Integration with bathymetric and oceanographic sensors
- Touchdown monitoring of subsea structures
- Wave height measurement

Full digital synthesis of transmit and receive frequencies, together with greatly improved input dynamic range.

Benefits

- Millimetre resolution capability
- Use for distance measurement
- Compact and low weight
- Various connector options
- Highly configurable design

Features

- Analogue output
- Digital output
- Free running output
- Interrogated output
- Optional low operating voltage
- 700m, 4000m or 6800m ratings

Tritech's digital precision altimeters offer configurable design with a wide range of options available. OEM configurations include, for example, low magnetic signature rigid Delrin™ (Plastic) housings or supplied with a right-angled transducer.

Output for the PA200 or PA500 can either be simultaneous analogue and digital outputs, allowing them to be interfaced to a wide range of PC devices, (including operated through Tritech's data acquisition and logging software, Seanet Pro), data loggers, ROV telemetry systems and multiplexers. The 500kHz PA500 Altimeter is supplied with Tritech's 700 series bathy.

In addition, Tritech's altimeters are supplied with AltTest diagnostic software which provides a simple way of communicating with Tritech altimeters and displays real-time current and average data. AltTest is compatible with all configurations of the Tritech PA200 and PA500 altimeter.

Key Specification	
Operating frequency	200kHz or 500kHz
Beamwidth	20° & 6° conical
Depth rating	700m - 6800m / 2296.59ft - 22,309.7ft
Weight in water	0.8kg / 1.77lbs

Acoustic specification	PA200		PA500	
Operating frequency	200kHz		500kHz	
Beamwidth	20° conical		6° conical	
Range	0.7m to 50m	1m to 100m	0.3m to 50m	0.1m to 10m

Resolution	
Digital	1mm
Analogue	0.025% of range

Electrical and communications	
Supply voltage	24 VDC at 80mA or 12VDC at 160mA
Analogue output	0 to 10VDC (with 24V power supply), 0 to 5VDC or 4 to 20mA
Communication	RS232 or RS485
Output modes	Free running, interrogated or part of multidrop network

Physical specification	
Depth rating	700m / 4000m / 6800m* ¹ 2296.59ft / 13,123.36ft / 22,309.7ft
Materials	Dependent on depth, as shown above for straight transducer models. All right-angle transducers are ABS
Weight in air	1.15kg / 2.54lbs
Weight in water	0.8kg / 1.77lbs
Operational temperature	-10°C to 35°C / 14°F to 95°F
Storage temperature	-20°C to 50°C / -4°F to 122°F

*¹Housing dependant

Specification subject to change in line with Tritech's policy of continual product development

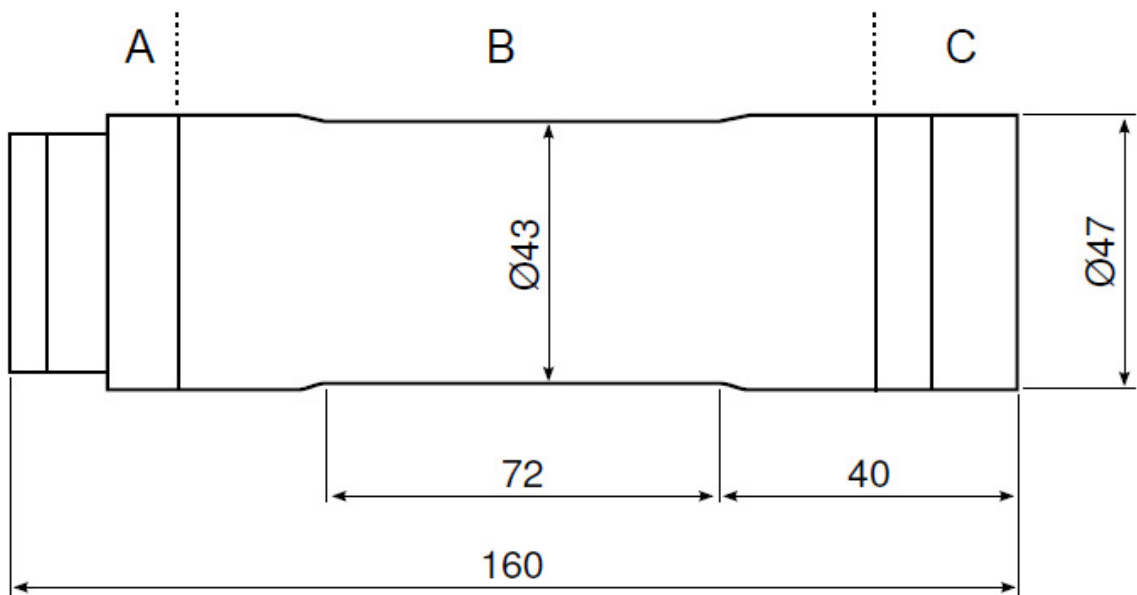

Not to scale. Measurements in mm.

Tritech International Limited
Peregrine Road, Westhill Business Park
Westhill, Aberdeenshire AB32 6JL
United Kingdom
Email: sales@tritech.co.uk
Tel: +44 (0)1224 744111

